

M/Y Taka



*Fine Yacht by
Sparkman & Stephens USA*



A FEW NOTES ABOUT THE DESIGNERS SPARKMAN & STEPHENS:

Over four decades, S&S designed every single America's Cup winner but one – an astonishing achievement unlikely to ever be repeated.

As the yachting industry shifted from wood to fiberglass and from one-off designs to production brands, Sparkman & Stephens remained a designer of choice. High-end builders including Abeking & Rasmussen, Baltic, Concordia, Derecktors, Hinckley, Hylas, Lyman Morse, Morris, Nautor Swan, Northwind, Palmer Johnson, Shaw, Stellar, Tartan, Queen Long, and others boasted of designs by S&S in their advertising. Simultaneously, commissions for unique Sparkman & Stephens yachts – sail and power – continued to flow in from the major figures of the 20th century: Aga Khan, Baker, Disney, DuPont, Ford, Heath, Johnson, McGraw, Mosbacher, North, Reynolds, Rockefeller, Rothschild, Schaefer, Scripps, Sears, Turner, Vanderbilt, Watson, and many, many others.

The firm's legacy remains sterling, even today; to wit: a high-end broker recently concluded a listing summary:

**"She is a Sparkman & Stephens' design.
What more needs to be said?"**







ACCESSIBILITY

Accessibility features for guests with disabilities

Extra large gangway

Stair lift (Main to Upper Deck)

2 cabins on main deck

Wide walk around



USA built Gentleman's Yacht



















Twin cabin (Port)

Twin cabin (Stbd)





Single cabin



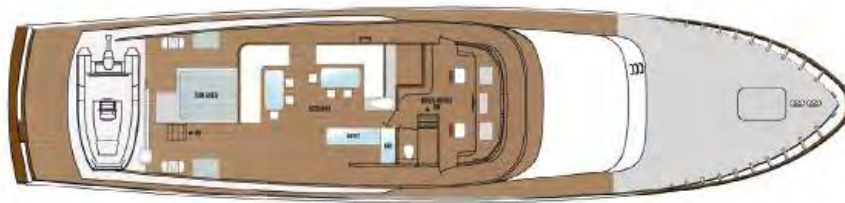

NAVIGATION - SUN DECK



MAIN DECK

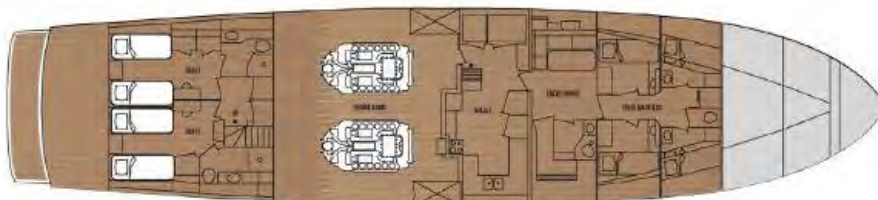

LOWER DECK

Welcome on board

m/y **Taka**

